

PRESENTS



BAHAY TIBAY

P145,000 ONLY



Storm Proof

Can be built in 24 hrs*

24 sqm floor area

Fully customizable



*three 8 hr shifts

THE BAHAY TIBAY COMES COMPLETE WITH:

- Pre-fab GI wall frames
- Pre-painted Galvalume wall cladding
- JacintoColor's patented Panelized Roofing with insulation
- GI windows
- Flush and PVC doors
- Inner partition for a bathroom
- Pail-flush toilet bowl

**STRUCTURALLY CERTIFIED TO WITHSTAND
250KPH WINDS.**

All Bahay Tibay units use quality **zinc-coated GI steel** and pre-painted **Galvalume steel**.

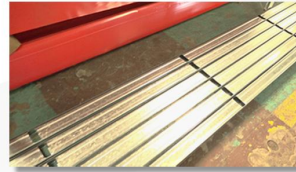

All its components are **pre-fabricated** in JacintoColor Steel's plant.



Assembly can be completed in 24 hrs.

Due to the high ceiling and **Panelized Roofing**, the **storm-proof** Bahay Tibay remains cool on the inside.

How is it installed?



1. The site requires a **4 inch** concrete slab.

2. Installation begins with the wall frames, which are bolted to the ground.



3. Installation of the Pre-fabricated **Panelized Roofing** follows.

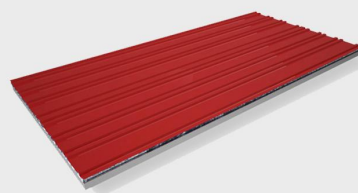

4. Gutters and other banded materials are installed.



5. Wall cladding is laid on.

6. The doors and windows are the final steps in the installation.



7. And the Bahay Tibay is complete.

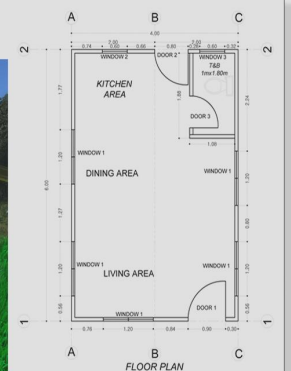

HOTLINE: 219-8484

mobile: +63 9178751867

E-mail us at admin@jacintocolor.com

Jacinto Compound, Km, 21 Quirino Hi-way, Novaliches, Quezon City
Telefax: 930-1872 / 937-5867